

MONTAGEANWEISUNG

INSTRUCTION OF ASSEMBLY

TUBIS T5/T8 PRR 800/..

IP68*, 2m / IPX9K**

PRACHT®

Zertifiziert nach DIN ISO 9001

Alfred PRACHT Lichttechnik GmbH | PRACHT Lighting Solutions GmbH
Am Seerain 3, 35232 Dautphetal-Buchenau, Germany
Tel. +49 6466 9140-0, Fax +49 6466 9140-444
info@pracht.com, www.praecht.com

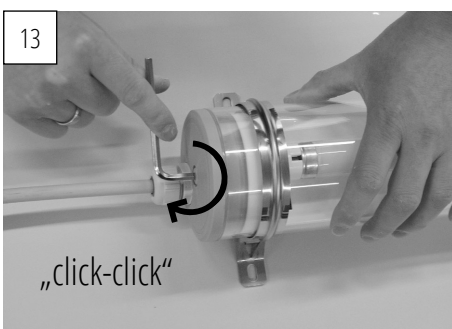
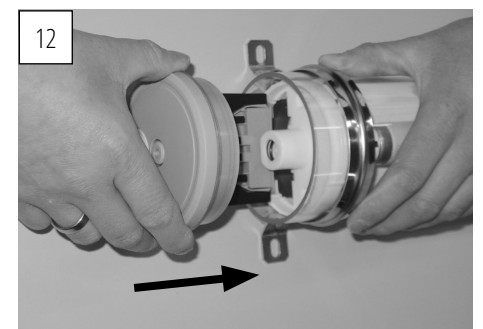
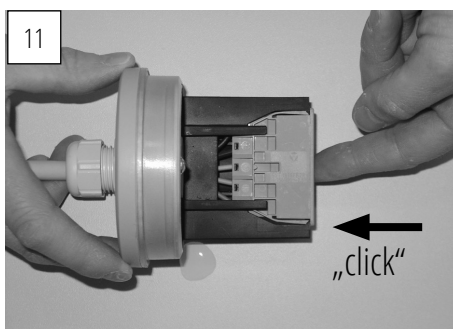
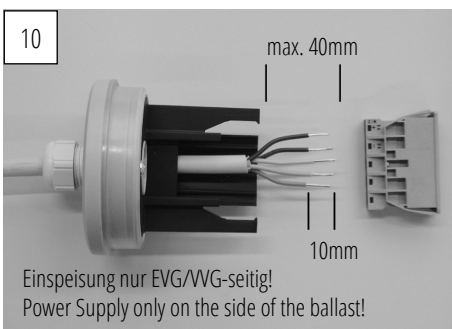
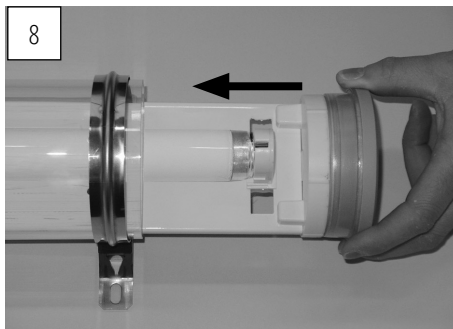
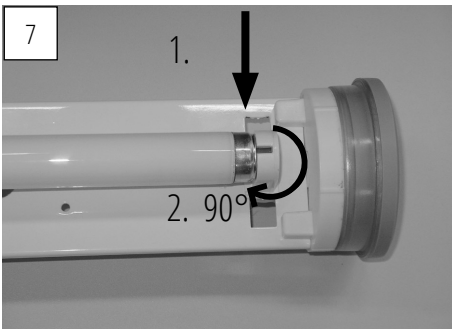
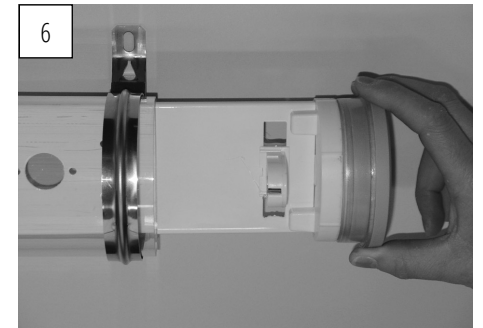
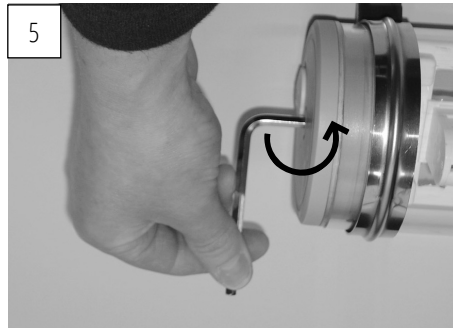
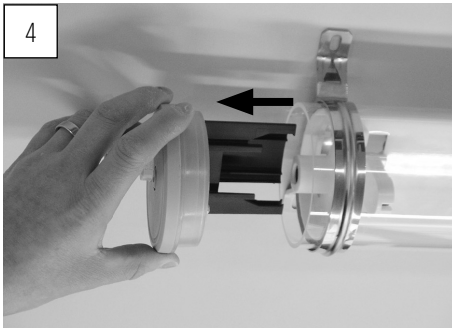

D Zur Verwendung in einer Umgebung in der eine Ablagerung von leitfähigem Staub auf der Leuchte erwartet werden kann.

This luminaire is useable in an environment that is expected to deposit conductive dust.

* IP68, 2m Nicht für den dauerhaften Betrieb unter Wasser oder für fließende Gewässer geeignet. Not suitable for continuous under water or flowing water operation.

** IPX9K Siehe/see www.praecht.com/InformationSchutzart

DURCHGANGSVERDRÄHTUNG/ THROUGH WIRING:

Strombelastung/rating	Leiterquerschnitt/wire cross-section
10A	= 1,5mm ²
16A	= 2,5mm ²

MONTAGEARTEN:

Decken-, Pendel-, waagerechte und senkrechte Wandmontage

INSTALLATION:

Ceiling, pendant, horizontal and vertical wall mounting.

Art.-Nr. 0709956